

Item	Description	Part Number	Qty
1	Manual Actuator Handle	18900- 20995	1 per valve
2	Screw	0515- 0982	4
3	Manual Valve Control Panel	18900- 00950	1
4	Spacer, Round .625 lg	0380- 0010	4
5	Valve Actuator Coupler	18900- 20990	1 per valve
6	MS 4 x 0.7 x 16 mm long	0515- 0071	2 per bracket
7	Micrometering Needle Valve Mounting Bracket	18900- 00430	up to 2
8	Valve Box Top	19238-00030	1
9	MS 4 x 0.7 x 8 mm long	0515- 0106	2
10	Insulator	0340-0647	1
11	Insulation Plate	19358-00030	1
12	MS 3 x 0.5 x 20 mm long	0515- 0057	2 per valve
13	Heated Block	19358-20520	2
14	Screw, M3 x 12 mm	0515-0105	2
15	Valves (Refer to Figure 5)		up to 4
16	Rectangular Standoff	19238-20500	2
17	Valve Box Bottom	19238-00010	1
18	Shoulder Screw	19238- 20510	2
19	Socket Head Screw, M4 x 8 mm	0515-0153	2
20	Screw, M3 x 8 mm	0515-0104	4 per heated block
21	Heater/Sensor Cable Assembly, C/O	05890-61140	1 per heated block
22	● Cartridge Heater, 70W	19231-60620	1
23	● Contact	1251- 1679	2
24	● PRT Sensor	19231-60660	1
25	● Contact	1251- 5963	2
26	● Flexible Sleeving, (ordered by the inch)	0890-0737	22
27	Hex Standoff, M3 x 16 mm	0380-1102	4 per heated block
28	Actuator Handle Set Screw	3030- 0079	1 per valve
<b>Items Not Shown:</b>			
	Hex Key Wrench, 3 mm A/F	8710- 0911	1
	Column Retaining Bracket	05890- 80660	4
	Tie Wraps	1400- 0249	4
	Adhesive Marker "A"	7120- 5376	1
	Adhesive Marker "1"	7124- 0438	3
	Adhesive Marker "2"	7124- 0439	3
	Adhesive Marker "3"	7124- 0440	3
	Heater Connector Shell	1252- 0757	1

**Figure 2. Manual Valve Box Assembly (Sheet 1 of 2).**

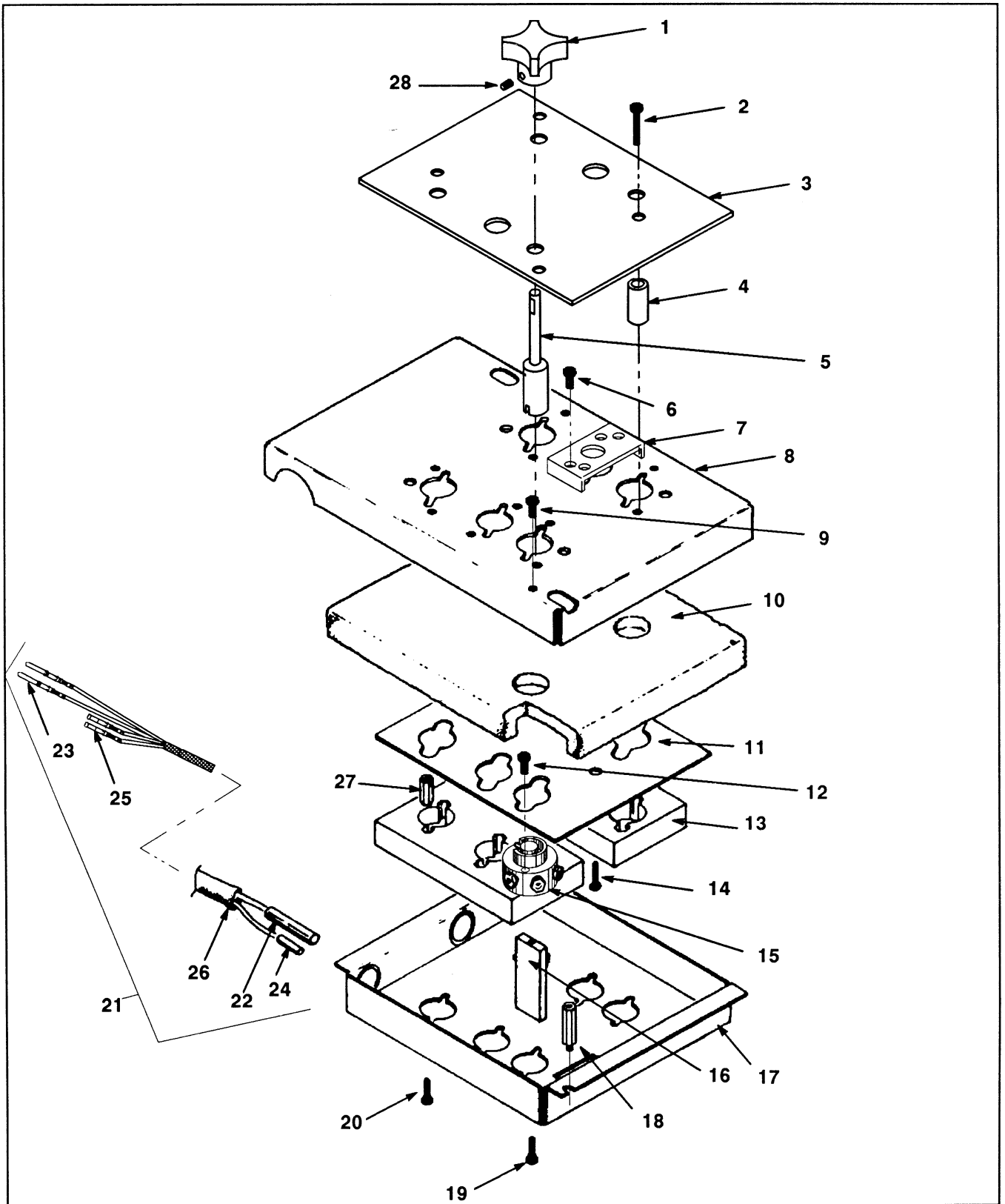

Figure 2. Manual Valve Box Assembly (Sheet 2 of 2).